

24C CUSTOM MODEL
24S STANDARD MODEL



CAPE DORY CRUISING TRAWLER

A proven heavy duty workboat now designed for coastal cruising — seakindly, fuel efficient, unsinkable.

CAPE DORY CRUISING TRAWLER

24C CUSTOM MODEL AND 24S STANDARD MODEL

The Cape Dory 24C is a ruggedly built, heavy weather, full displacement cruising yacht with big boat capabilities. Her design has been proven in all types of weather conditions in New England waters as a coastal and offshore cruiser.

Expressly designed for cost-conscious sportsmen and cruising families, the CDT/24C has a full displacement hull which provides exceptional sea-keeping abilities and outstanding fuel efficiency.

From her large cockpit to her unique cruising interior—galley, dinette, shower—the CDT/24C is finished like a fine yacht by the New England craftsmen of Cape Dory Yachts. The spacious, well appointed interior invites overnight cruising. Forward are two wide berths that serve double duty when used with our convertible dining table. Her galley is complete with a urethane insulated ice box, alcohol stove, stainless steel sink and ample deep drawers and locker storage. Her huge companionway hatch

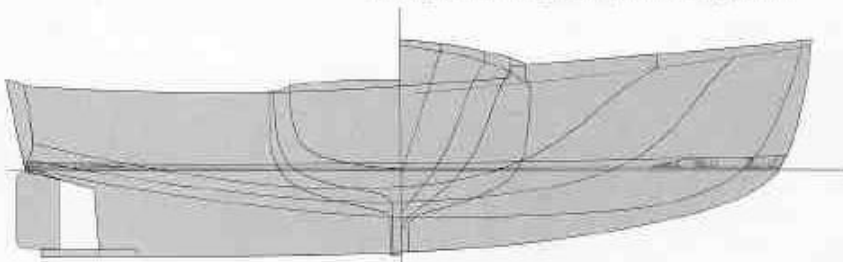

opens to provide unlimited head room in the galley area. A unique head arrangement includes a shower and slatted teak shower seat.

The custom model galley and shower are backed up with 50 gallons of water and the head is serviced with a 30 gallon built-in holding tank with an offshore pump-out.

Ash ceilings and a teak and holly sole combine to make the CDT/24C an exceptionally attractive, functional and comfortable cruising vessel. With the optional sail rig the 24C smooths out those rough seas, improves fuel economy and will get you back to port if necessary.

A solid value for years of service plus economical operation.

The Cape Dory Cruising Trawler 24 is a great compact boat for the cruising sportsman. She cruises easily at 6.25 knots, burning $\frac{3}{4}$ of a gallon per hour. With her large 30 gallon aluminum fuel tank, she can run for 37 hours at hull speed, giving a cruising range of approximately 230 miles.

The standard Westerbeke 4 cycle, 4 cylinder, 30 horsepower diesel is quiet and smooth running with power to spare for bucking heavy seas, currents or headwinds. The engine is geared low and swings a large 17" x 14" propeller.

Rugged Dependability

With a substantial weight for a boat her length and a low power requirement to drive her at hull speed, the CDT/24C is built to very heavy construction standards. She's a hard-working vessel that will take a great deal of use with limited maintenance.

Positive foam flotation makes the CDT/24C virtually unsinkable. An optional steadying sail adds even more stability and comfort.

A multi-use trailerable workhorse.

The CDT/24C has an eight foot beam to make her trailerable for transporting and launching near your favorite cruising area, and to provide the economy of home storage and maintenance.

A salty seagoing cruiser for the serious boatman.

L.O.A. 24'0" Engine Westerbeke 27 4
 L.W.L. 22'4 1/2" cycle, 4 cyl. FWIC
 B.W.L. 7'2" diesel
 Beam 8'0" 30 hp @ 3000
 Draft 3'1" RPM
 Disp. 5,250 lbs 2.83:1 Hurth Gear
 Fuel 30 gallons diesel Prop 17" x 14" 3 blade

CDT/24C CUSTOM MODEL

CUSTOM MODEL \$34,900.



- Fresh Water Cooled Westerbeke 30 H.P. 4 Cylinder Diesel Engine
- 85 Sq. Ft. After Deck
- 110 Volt AC Power
- Enclosed Shower With Teak Slatted Seat
- Marine Head — 30 Gal. Holding Tank, with Off-shore Overboard Discharge
- Positive Foam Flotation
- Polished Bronze Opening Ports
- Pressure Hot and Cold Water System with Manual Backup

CUSTOM MODEL STANDARD FEATURES

Full molded foredeck and house
 Bronze and stainless hardware and grabrails
 Teak and brass gunwale guards
 Teak side decks and toe rails
 3/16" tempered solex, tinted safety glass windshields
 Sliding side windows
 Integral anchor locker w/drain
 Tinted lexan hatch
 Locking companionway hatch
 V-berth w/pedestal table converts to v-berth filler
 Teak and holly sole
 5 cu. ft. ice box, fully insulated
 2 burner alcohol stove
 Shower curtain
 Teak shower grate and fiberglass sump
 Privacy curtain
 Companionway curtain
 Showerall faucet adapter
 Large stainless sink
 Manifold water system
 50 gallon fresh water in 2 tanks
 110 volt AC hot water heater
 2-12 volt batteries
 30 gallon aluminum fuel tank

Full instrumentation
 Fuel filter/water separator
 Sound proofed engine room
 Fiberglass waterlock
 Wet exhaust
 Rule electric bilge pump
 Fore and aft chase tube for wire and hose
 Fiberglass stern tube w/long life bearing
 Water injected stuffing box
 1 1/2" stainless steel rudder shaft
 17" x 14" 3 blade prop 1 1/4" bronze prop shaft
 Balanced rudder
 Stainless steel rudder gudgeon and shoe
 Integrated bonding system
 Zinc anode
 Electrical ground plate
 Navigation lights
 Cabin lights
 Emergency tiller
 Transom bench seat and storage locker
 Remote control spotlight on pilothouse
 Electric horn on pilothouse

OPTION LIST

Sailing rig, main furling and jib furling systems, Sails, standing and running rigging and lightning ground protection	\$4,200.00
Solid teak planked cockpit sole	2,000.00
Compass (Ritchie DN-46-BI 4")	315.00
Compass (Ritchie HD-74) 4"	160.00
Datamarine digital depth sounder w/alarm	680.00
Datamarine digital knot log	680.00
VHF radio standard	
Horizon w/antenna	650.00
Launching trailer w/winch	3,350.00
Optional fabric interior cushions	85.00
Pilothouse canvas enclosure	450.00
Canvas camper top enclosure	P.O.R.*
Bow rail (stainless)	275.00
Split cockpit stern rail (stainless)	600.00
Stern ladder (stainless)	250.00
50 foot shore power cord	110.00
Options Total	\$ _____
Custom Model	\$ 34,900.
Freight & Commissioning	\$ _____
Sales Tax	\$ _____
Total Price	\$ _____

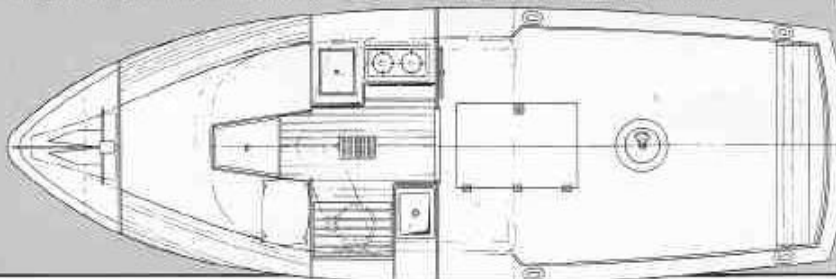

*Price On Request

L.O.A. 24'0" Engine Westerbeke 27.4
 L.W.L. 22'4 1/2" cycle, 4 cyl. FWC
 E.W.L. 7'2" diesel
 Beam 8'0" 30 hp @ 3000
 Draft 31" RPM
 Disp. 5,250 lbs 2.83:1 Hurth Gear
 Fuel 30 gallons diesel Prop 17"x14" 3 blade

CDT/24S STANDARD MODEL

STANDARD MODEL \$26,900.



- Fresh Water Cooled 4 Cyl. 30 H.P. Westerbeke Diesel Engine
- Positive Foam Flotation
- 85 Sq. Ft. Cockpit Area
- V-Berth with Pedestal Table/Converts to V-Berth Filler

STANDARD FEATURES

Fully molded foredeck and house
 Bronze and stainless hardware and grabrails
 Teak side decks and toe rails
 Integral anchor locker with drain
 3/16" tempered solex tinted safety glass windshields
 Sliding side windows
 Tinted lexan hatch
 High density extruded PVC gunwale guards
 Locking companionway and hatch
 5 cubic ft. ice box, fully insulated
 2 burner alcohol stove
 30 gallon fresh water tank with hand pump and sink
 30 gallon aluminum fuel tank
 Cabin lights
 1-12 volt battery
 Full instrumentation
 Heavy duty fuel filter/water separator
 Fiberglassed waterlock
 Sound proofed engine room
 Wet exhaust
 Fore and aft chase tube for wire and hose
 Fiberglass stern tube with long life bearing
 Water injected stuffing box
 17" x 14" 3 blade prop
 1 1/4" bronze prop shaft
 1 1/2" Steel rudder shaft
 Balanced rudder
 Integrated bonding system
 Zinc anode
 Emergency Tiller
 Navigation lights

STANDARD MODEL OPTION LIST

Sailing rig, main furling and jib furling systems.		Datamarine digital depth sounder w/ alarm	880.00
Sails, standing and running rigging and lightning ground protection	\$4,200.00	Datamarine digital knot log	680.00
Solid teak planked cockpit sole	2,000.00	VHF, Horizon w/ antenna	650.00
Head and holding tank	700.00	Remote control spotlight on pilothouse	275.00
Y-Valve discharge	350.00	Electric horn on pilothouse	115.00
Overboard discharge pump	450.00	Optional fabric, interior	85.00
Bronze opening ports (4)	1,100.00	Bow rail (welded stainless)	275.00
Pressure water, hot and cold w/ shower	950.00	Split cockpit stern rail (stainless)	600.00
24 gal. additional water tank	250.00	Stern ladder (welded stainless)	250.00
V-berth privacy curtain	250.00	Launching trailer w/ winch	3,350.00
Shower curtain w/ track	350.00	110 volt shore power	540.00
Companionway curtain	330.00	50 foot shore power cord	110.00
Pilothouse canvas enclosure	450.00	Second battery installed	140.00
Canvas camper top enclosure P.O.R.*		Aft cockpit seat/storage locker	850.00
Helmsman seats, port and starboard	1,200.00	Head cover/seat	275.00
Electric bilge pump	280.00	Options Total	\$ _____
Compass (Ritchie DN-46-B) 4"	315.00	Standard Model	\$ 26,900.
Compass (Ritchie HD-74) 4"	160.00	Freight & Commissioning	\$ _____
		Sales Tax	\$ _____
		Total Price	\$ _____

*Price On Request

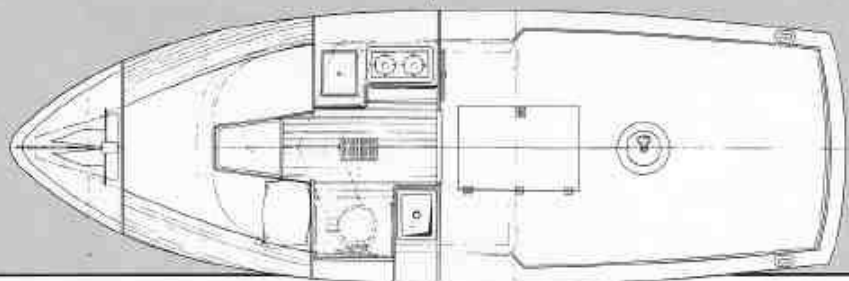



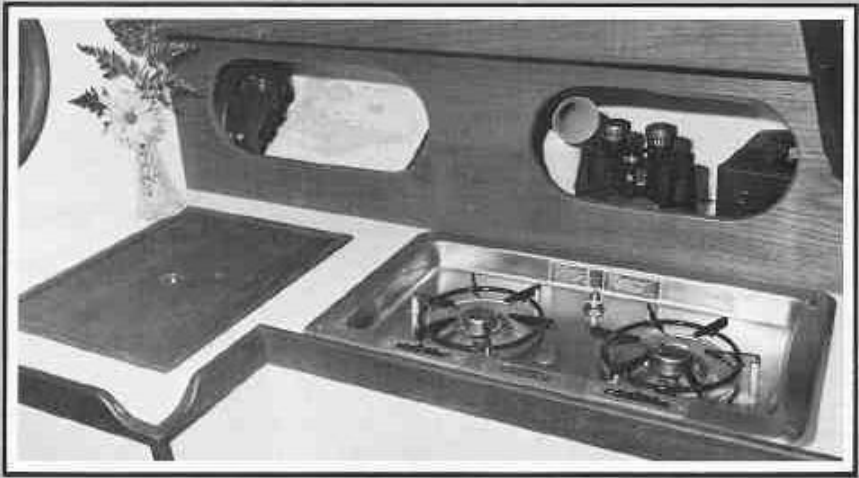

CAPE DORY CRUISING TRAWLER

24C CUSTOM MODEL
24S STANDARD MODEL

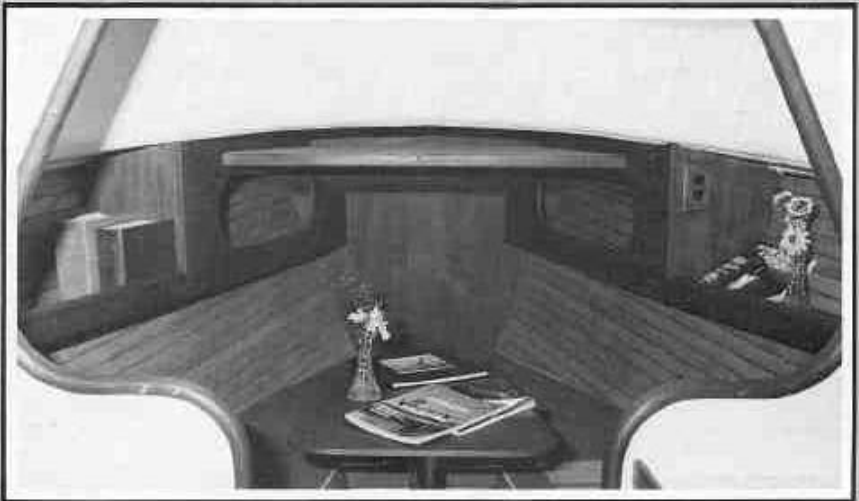

CDT-24
3H/M FUEL CONSUMPTION STUDY

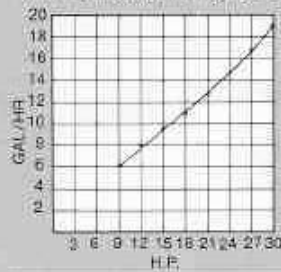

CDT-24
KNOTS/HP GRAPH

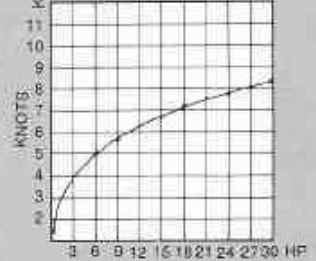

CAPE DORY TRAWLERS

160 Middleboro Ave., East Taunton, MA 02718 Tel: (617) 823-6776

Specifications and prices subject to change without notice.

Printed in USA 9/85
© 1985, Cape Dory Trawlers, Inc.
Graphics: Thompson Associates, Warwick, RI